

# Topbox 4140







9.2.136

# Topbox 4140

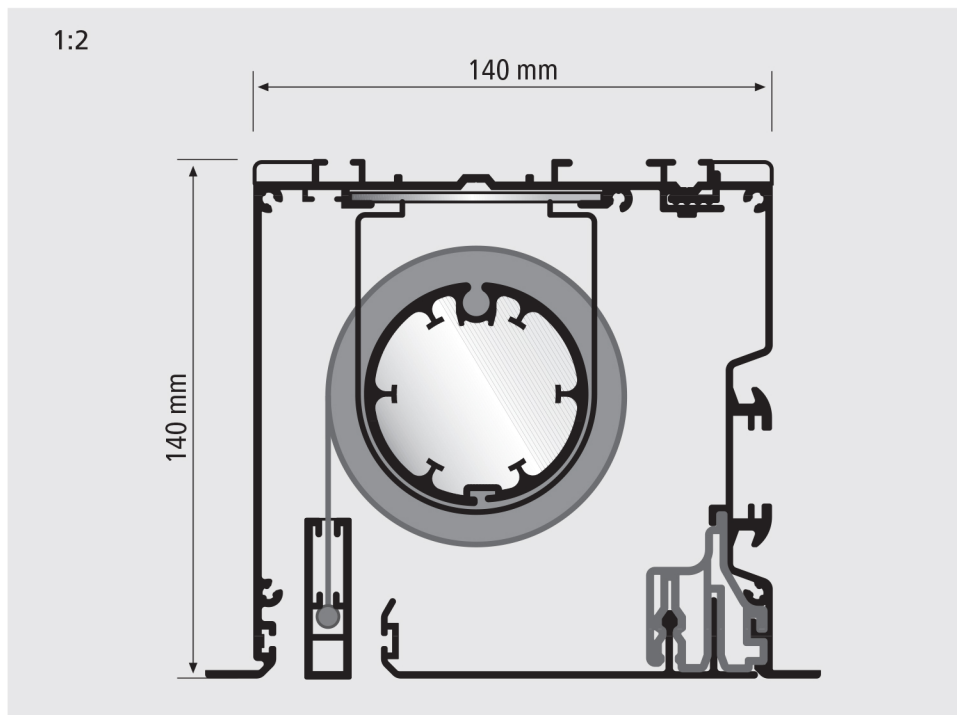

## SPECIFICATIONS

**BOXED ROLLER BLIND - OPERATED BY 230VAC/50-60HZ MOTOR**

**Applications:**

- Vertical

**Ambience:**

- Interior
- Recessed

**Fabrics:**

- Filtering
- Dim Out
- Black-out

**Headbox:**

- Square shape 140 x140 mm extruded aluminium 6060 T6 UNI 8278

**Brackets:**

- Steel brackets with aesthetical thermoplastic covers

**Winding Tube:**

- Ø49-60 mm 6060 T60 UNI 8278 aluminium tube with insert to facilitate insertion and replacement of the fabric

**Bottom Bar:**

- 6060 T60 UNI 8278 extruded aluminium rectangular shape with thermoplastic endcap

**Colours:**

- White

**Operating:**

- 230V/50Hz M50 tubular motor with end stop integrated. IP 44 Omologation

**Upper fixing:**

- Recessed

**Dimensions:**

- With aluminium winding tube 6060 T60 UNI 8278 Ø49-60 mm Max L 300 x H 400 cm

**Optional:**

- Tubular motor with RF radio receiver on board;
- Digital tubular motor with M2net RF radio receiver on board



9.2.138

# Topbox 4140



## RECOMMENDED WEIGHT

TOPBOX 4140 (1901R4)

H \ L	100	120	140	160	180	200	220	240	260	280	300	320	340	360	380	400
120	800 g	800 g	800 g	800 g	800 g	800 g	800 g	800 g	800 g	800 g	800 g	800 g	800 g	800 g	550 g	150 g
140	800 g	800 g	800 g	800 g	800 g	800 g	800 g	800 g	800 g	800 g	800 g	800 g	800 g	800 g	550 g	150 g
160	800 g	800 g	800 g	800 g	800 g	800 g	800 g	800 g	800 g	800 g	800 g	800 g	800 g	550 g	330 g	150 g
180	800 g	800 g	800 g	800 g	800 g	800 g	800 g	800 g	800 g	800 g	800 g	550 g	550 g	550 g	330 g	150 g
200	800 g	800 g	800 g	800 g	800 g	800 g	800 g	800 g	800 g	800 g	550 g	550 g	550 g	550 g	330 g	150 g
240	800 g	800 g	800 g	800 g	800 g	800 g	800 g	800 g	800 g	800 g	550 g	550 g	550 g	330 g	330 g	150 g
280	800 g	800 g	800 g	800 g	800 g	800 g	800 g	800 g	800 g	550 g	550 g	330 g	330 g	330 g	150 g	150 g
320	800 g	800 g	800 g	800 g	800 g	800 g	800 g	800 g	550 g	550 g	330 g	330 g	330 g	330 g	150 g	
360	800 g	800 g	800 g	800 g	800 g	800 g	800 g	550 g	550 g	550 g	330 g	330 g	330 g	330 g	150 g	
400	800 g	800 g	800 g	800 g	800 g	800 g	550 g	550 g	550 g	550 g	330 g	330 g	330 g	150 g	150 g	
440	800 g	800 g	800 g	800 g	800 g	550 g	550 g	550 g	550 g	330 g	330 g	150 g	150 g	150 g		

## LINKED BLINDS OPERATED SIMULTANEOUSLY

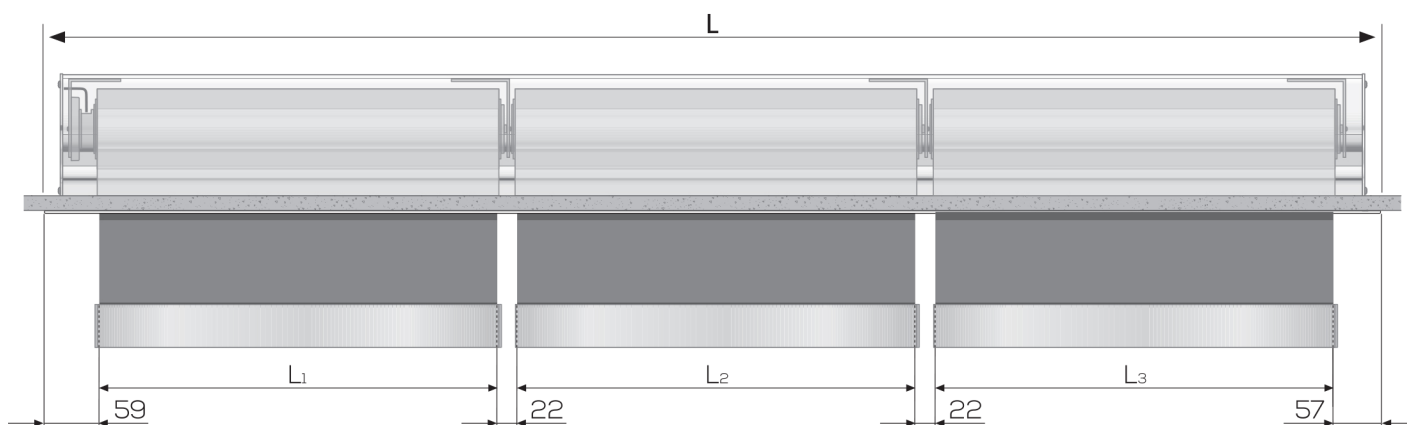

## LINKED BLINDS OPERATED INDEPENDENTLY

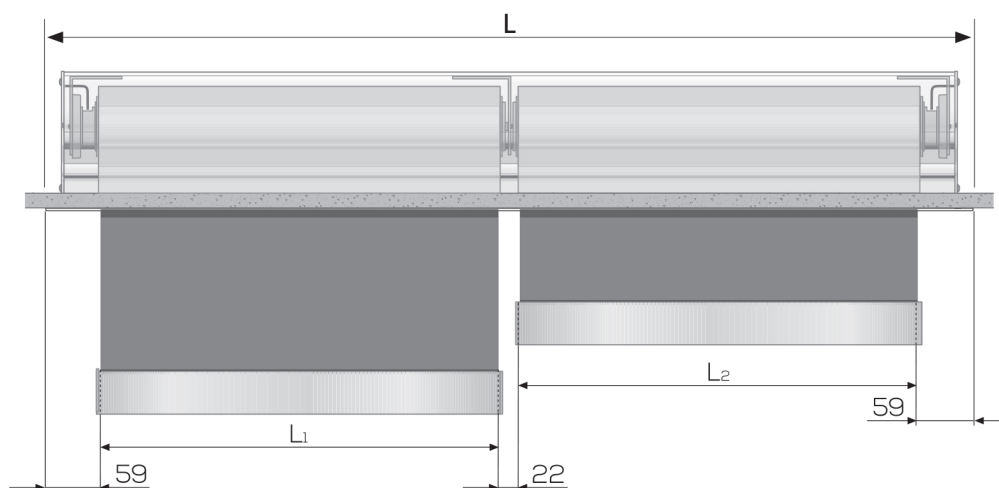

## INSTALLATION

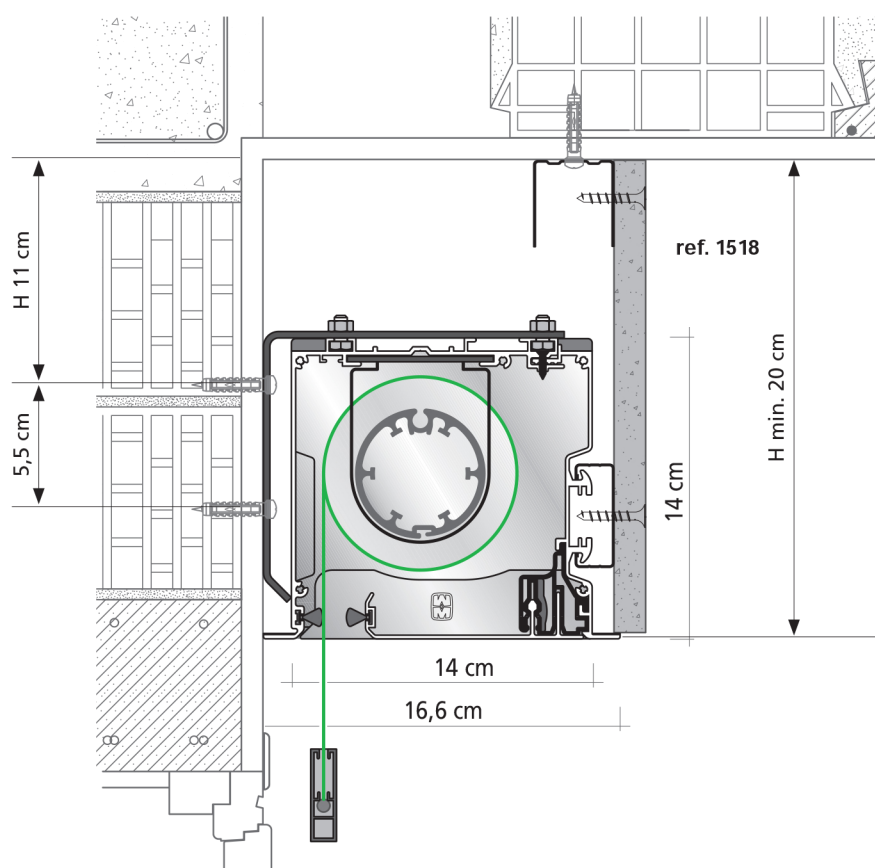
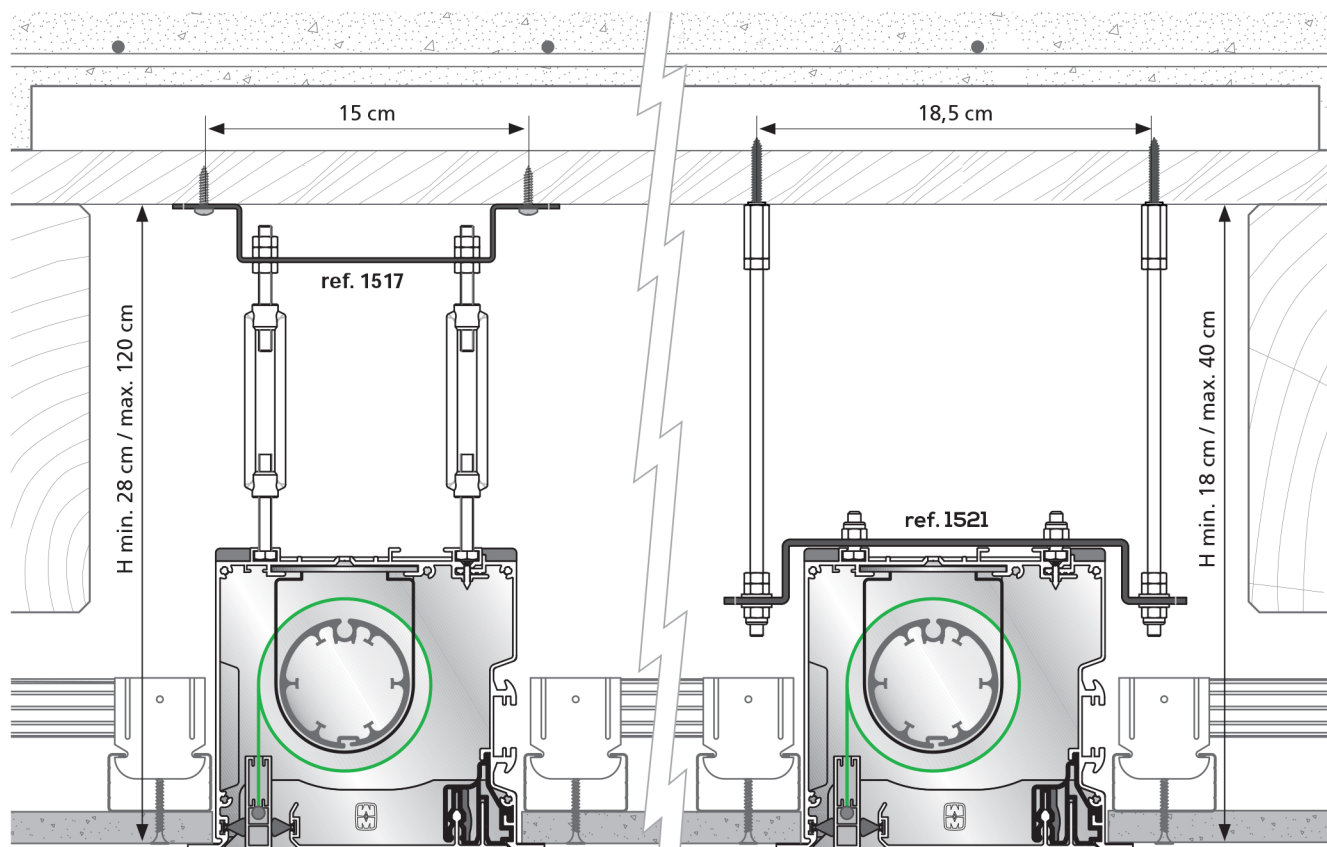





9.2.140

# Topbox 4140

## INSTALLATION

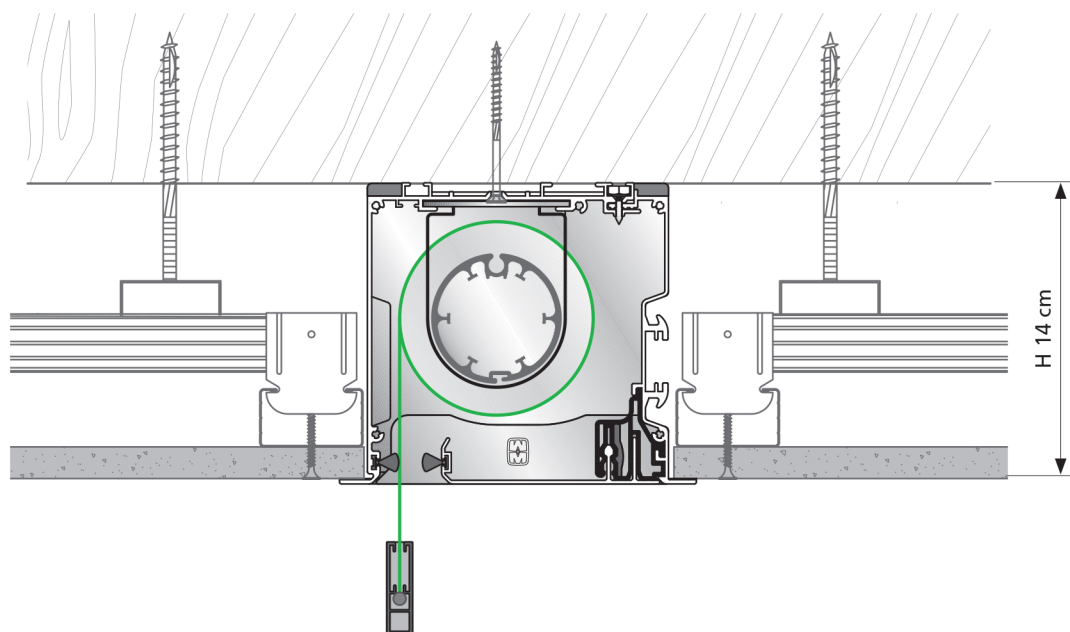
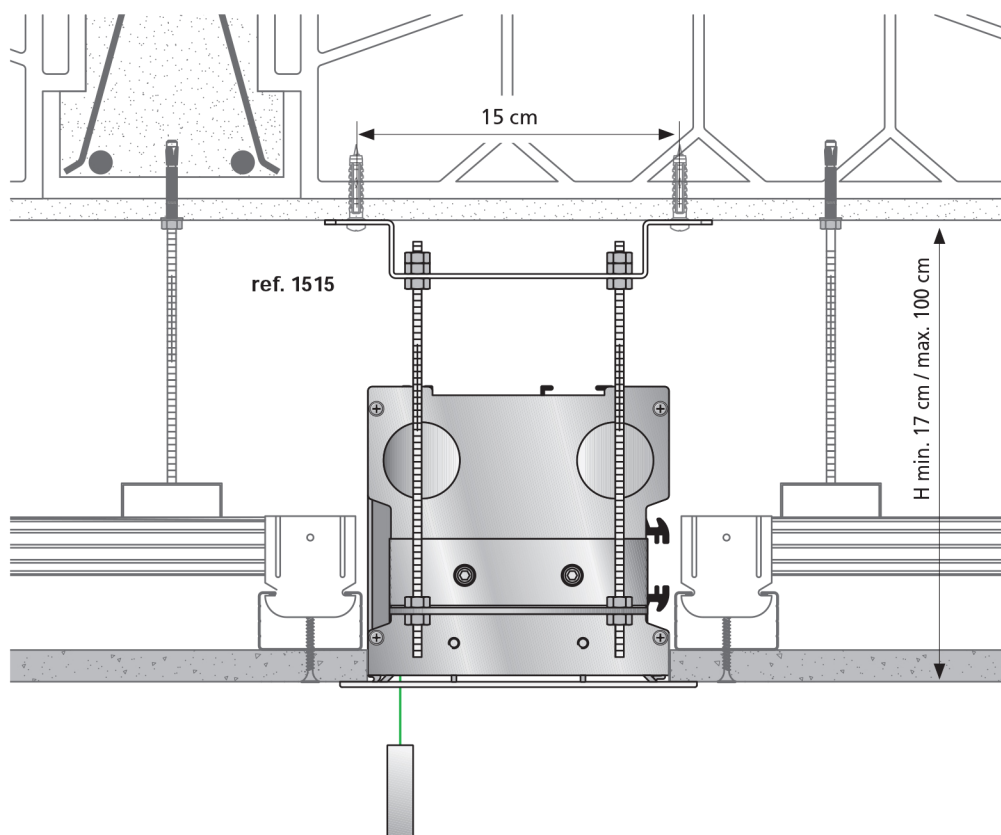

**fischer**   
innovative solutions

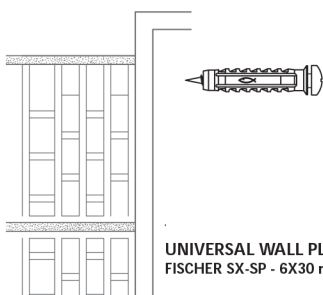

UNIVERSAL WALL PLUG  
FISCHER SX-SP - 6X30 mm

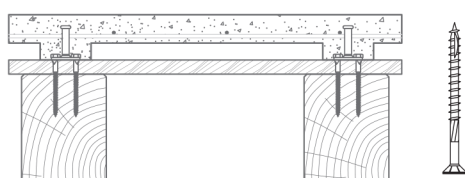

SELF-TAPPING SCREW  
POWER-FAST FPF-PZ 5,0 x 50 ZPF

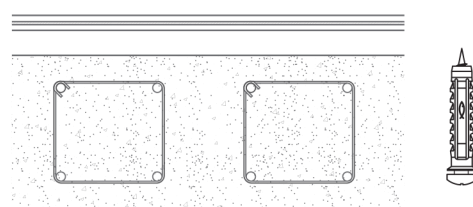

UNIVERSAL WALL PLUG  
FISCHER SX-SP - 6 x 30 mm (8 x 40 mm)

## REMOTE CONTROLS

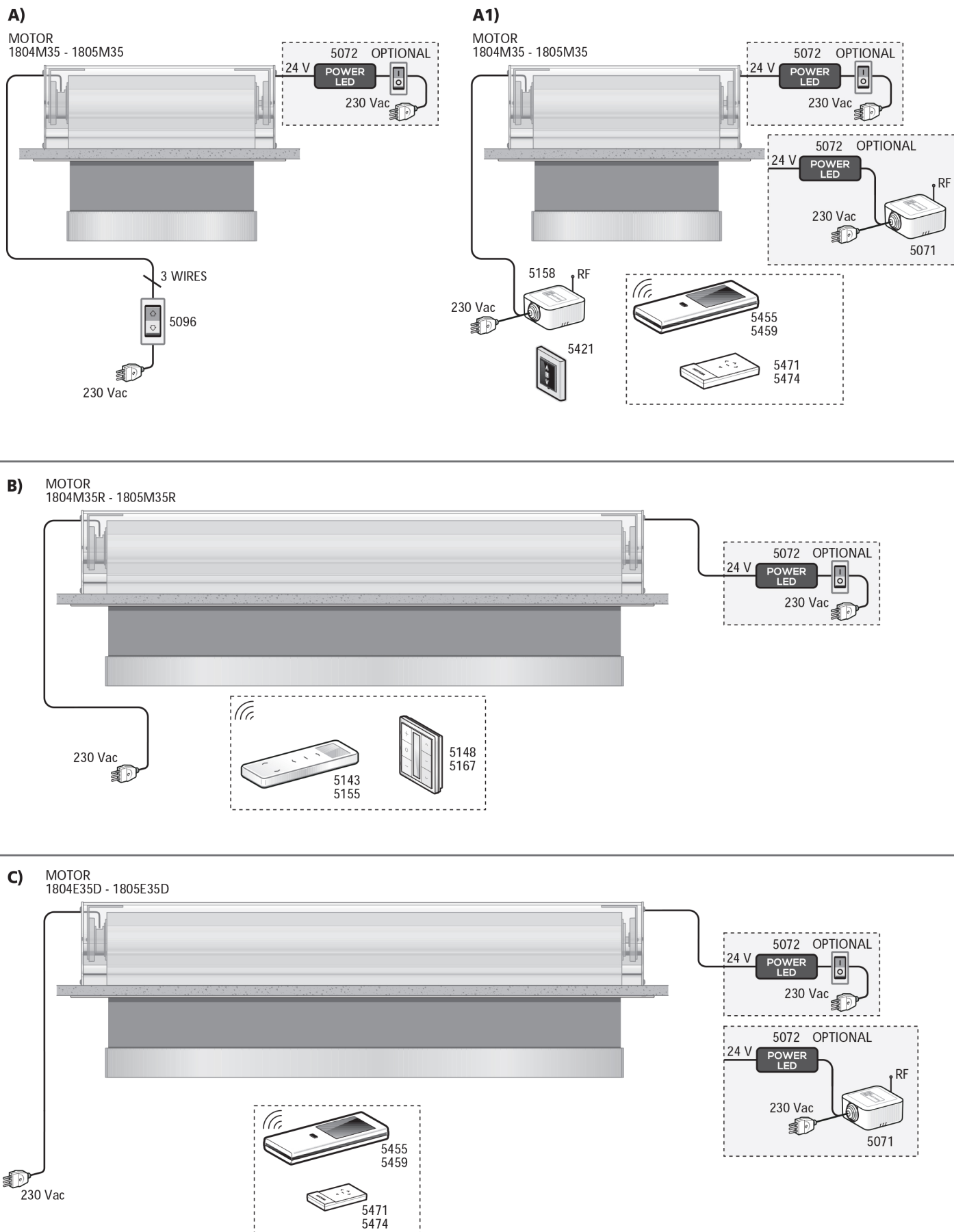



9.2.142

# Topbox 4140

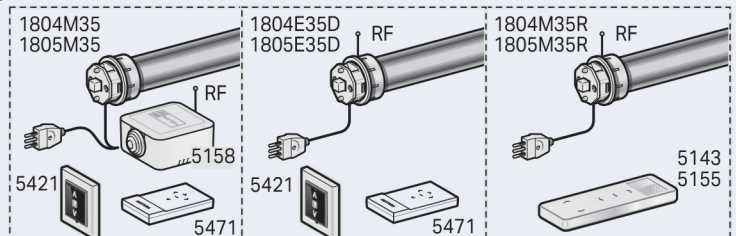
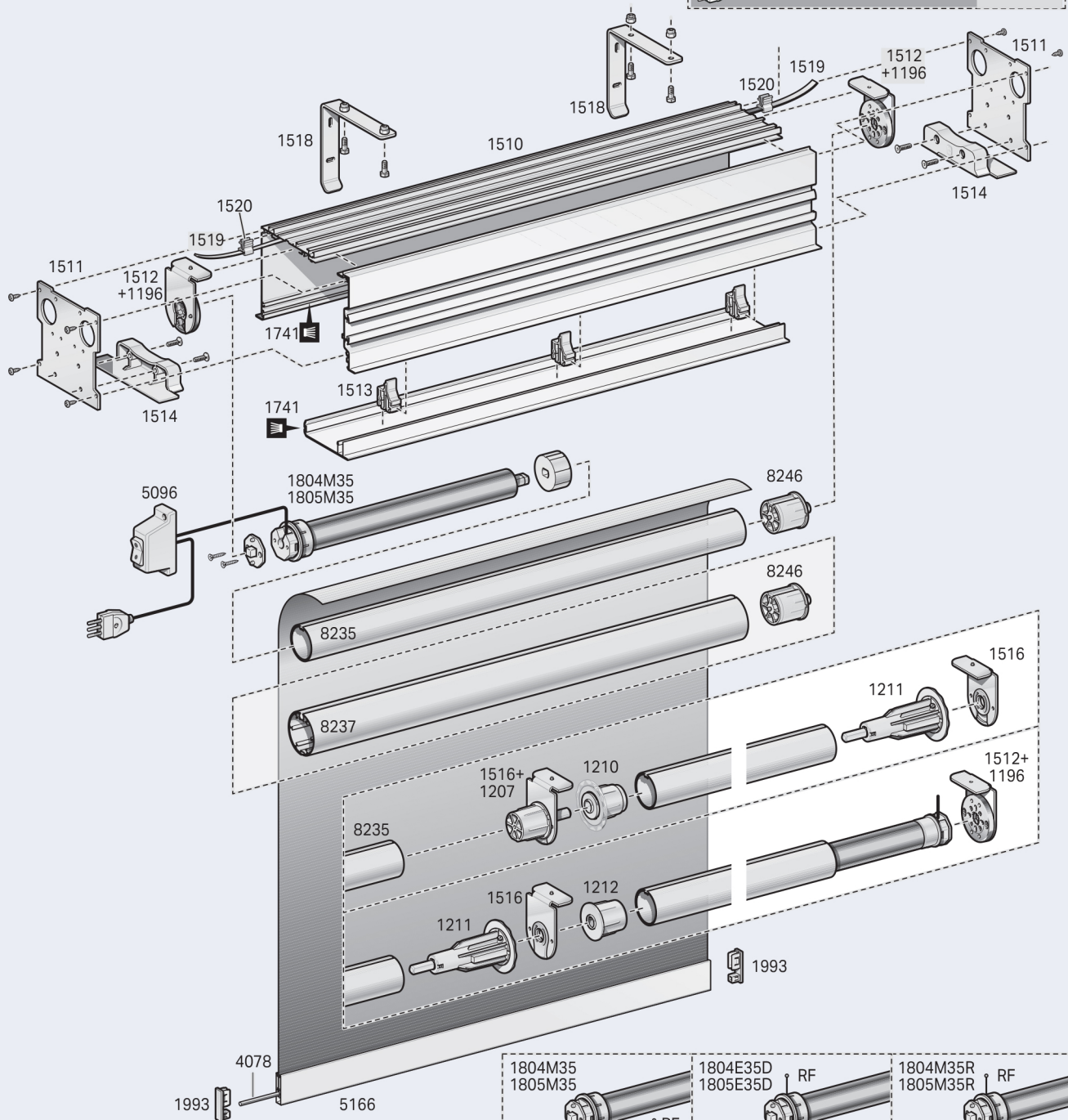
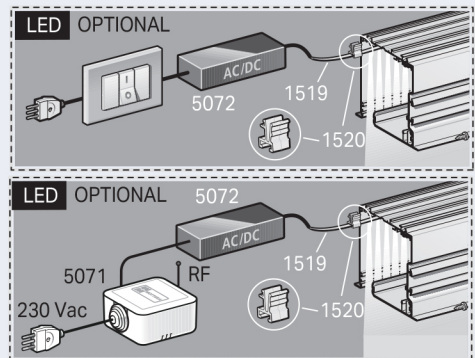
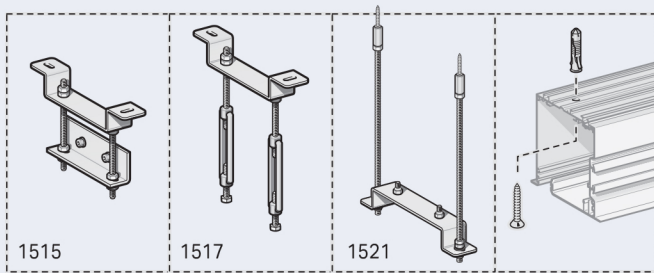



# Keeping you on the right **TRACK**

## CONCEALED TECHNOLOGY



CWF 4140 is a system for motorized roller blinds specifically for concealed installation in the ceiling.

The blinds are inside an aluminum box for easy installation in the false ceiling.

SEE HOW EASY IT IS TO **BUY ONLINE**

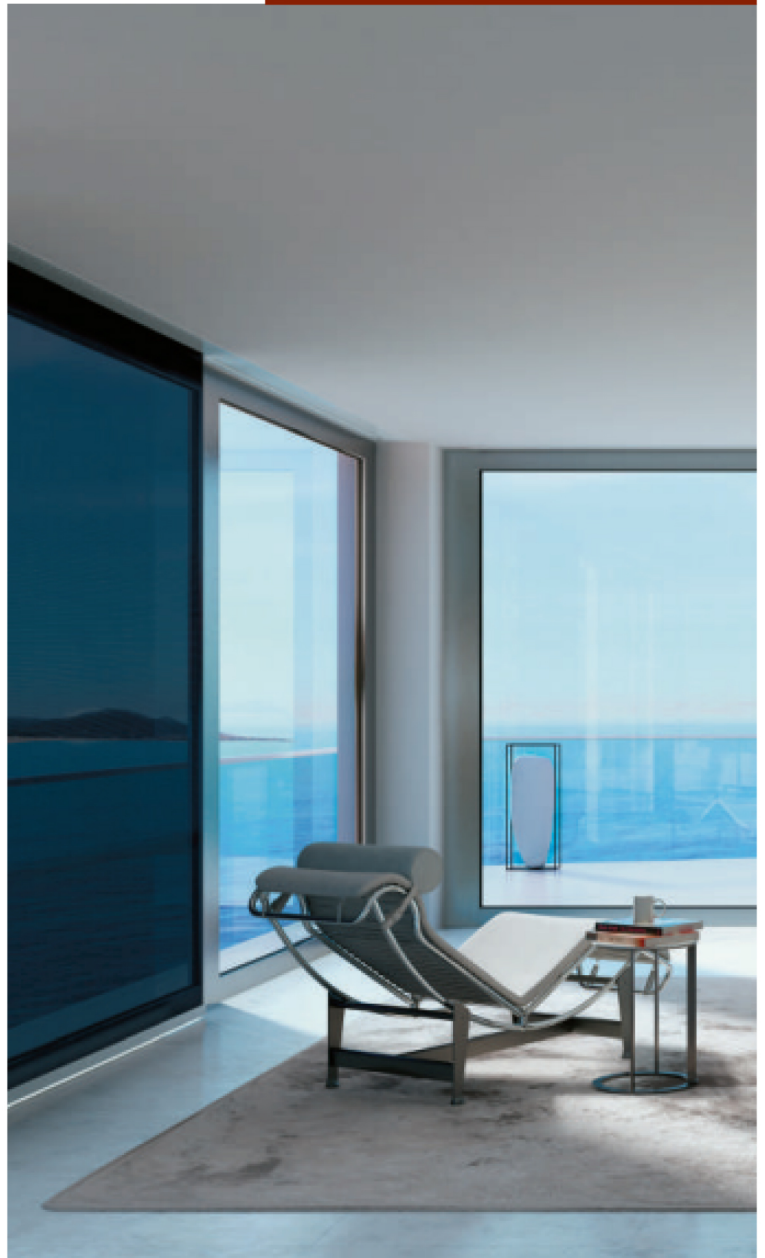

## **CONTACT US** / WE ARE HERE TO SERVE YOU

Make your order Online, by phone or email.

Questions or comments  
+353 (0) 44 9371038



Quotations and orders  
sales@cwf.ie



More information at  
www.cwf.ie



Corcoran Window Furnishings Ltd  
Multyfarnham Co. Westmeath, N91 WE08

### CWF TRACKS

We work closely with some of the Europe's leading manufacturers to design and source products focused on quality, availability and cost. From our own manufacturing facilities in the midlands we provide made-to-measure services on all our track systems as well as curtain, voile and panel track make-up services.